

SIDE MOUNT HOSE REELS WITH GUIDE ARM SG & SGW SERIES

COXREELS® SG & SGW Series expand the capabilities of the “Side Mount” spring driven hose reels, adding a multi-position guide arm for maximum and convenient hose control. Ideal for tight spaces, the versatile SG Series (for air/water, oil and grease) and SGW Series (for oxy-acetylene and T Grade gas welding hose) feature a simple two-bolt mounting pattern for easy installation and detachment on any vertical flat surface. Common applications include service vehicles, tool benches, vertical walls and beams, vehicle lift systems, machine tools and more. The guide arm and roller assembly are easily moved to one of the six different positions with a standard 13 mm wrench.

SG SERIES LOW PRESSURE

Models with hose are for air or water service with a maximum temperature 65° C. Models less hose can be used for air, water or oil. **Note: Do not exceed listed hose O.D. to obtain maximum length.**

HOSE							LESS HOSE		SIZE INDEX
MODEL	I.D. mm	O.D. mm	LENGTH m	BAR	Kg.	AVAILABLE IN EZ-COIL	MODEL	Kg.	
SG13-L125	6	13	8	21	11	EZ-SG13-L125	SG13L-L125	10	1
SG13-L135	6	13	11	21	12	EZ-SG13-L135	SG13L-L135	10	1
SG13-L325	10	16	8	21	12	EZ-SG13-L325	SG13L-L325	10	2
SG17-L350	10	16	15	21	18	EZ-SG17-L350	SG17L-L350	15	3
SG17-L430	13	19	9	21	19	EZ-SG17-L430	SG17L-L430	17	3
SG19-L450	13	19	15	21	24	EZ-SG19-L450	SG19L-L450	20	5

To order EZ-Coil® equipped models less hose, please add prefix “EZ-”

SG SERIES MEDIUM PRESSURE

Reels are furnished with standard one wire braid hose suitable for air, water or oil applications. Hose exceeds SAE R1 specifications. Maximum temperature 120° C. **Note: Do not exceed listed hose O.D. to obtain maximum length.**

HOSE							LESS HOSE		SIZE INDEX
MODEL	I.D. mm	O.D. mm	LENGTH m	BAR	Kg.	AVAILABLE IN EZ-COIL	MODEL	Kg.	
SG17-M325	10	17	8	207	21	EZ-SG17-M325	SG17L-M325	18	3
SG19-M350	10	17	15	207	29	EZ-SG19-M350	SG19L-M350	23	5
SG17-M425	13	21	8	172	21	EZ-SG17-M425	SG17L-M425	18	4
SG19-M450	13	21	15	172	29	EZ-SG19-M450	SG19L-M450	23	6

To order EZ-Coil® equipped models less hose, please add prefix “EZ-”

SG SERIES HIGH PRESSURE :: HP

Reels are furnished standard with S.A.E. 100R16 #1 or #2 wire braid hose suitable for grease and hydraulic oil applications. Maximum temp. 120° C. **Note: Do not exceed listed hose O.D. to obtain maximum length.**

HOSE							LESS HOSE		SIZE INDEX
MODEL	I.D. mm	O.D. mm	LENGTH m	BAR	Kg.	AVAILABLE IN EZ-COIL	MODEL	Kg.	
SG17-H125	6	14	8	345	20	EZ-SG17-H125	SG17L-H125	18	4
SG19-H150	6	14	15	345	28	EZ-SG19-H150	SG19L-H150	23	7
SG17-H325	10	17	8	276	21	EZ-SG17-H325	SG17L-H325	18	4
SG19-H350	10	17	15	276	29	EZ-SG19-H350	SG19L-H350	23	8

To order EZ-Coil® equipped models less hose, please add prefix “EZ-”

SGW SERIES WELDING HOSE REELS :: SGW

Hose supplied on reel Oxy-Acetylene or T-Grade. Oxy-Acetylene is twin-siemese type meeting R.M.A. and C.G.A. type V.D. grade R specifications. Use of other types of hose is not recommended. Reels with “T Grade” hoses are used for a wide variety of gases, such as MAPP, propane, natural and fuel. **Note: Do Not Exceed Listed Hose O.D. To Obtain Max. Length.**

HOSE							LESS HOSE		SIZE INDEX
MODEL	GAS	I.D. mm	LENGTH m	BAR	Kg.	AVAILABLE IN EZ-COIL	MODEL	Kg.	
SG17W-150	Oxy/Act	6	15	14	27	EZ-SG17W-150	SG17WL-150	21	9
SG19W-175	Oxy/Act	6	23	14	35	EZ-SG19W-175	SG19WL-175	27	10
SG17WT-150	T Grade	6	15	14	27	EZ-SG17WT-150	SG17WTL-150	21	9
SG19WT-175	T Grade	6	23	14	35	EZ-SG19WT-175	SG19WTL-175	27	10

To order EZ-Coil® equipped models less hose, please add prefix “EZ-”. Less hose SGW Series models comes with inlet hose

REEL DIMENSIONS

Technical Data Sheets Available On Website

SIZE INDEX	W mm	H mm	L mm	Y mm	M mm
1	159	394	343	356	64
2	171	394	343	356	64
3	171	495	432	457	64
4	184	495	432	457	64
5	216	559	495	521	73
6	238	559	495	521	73
7	229	559	495	521	73
8	241	559	495	521	73
9	225	495	432	457	64
10	267	559	495	521	64

Overall Dimensions Base Mounting Pattern

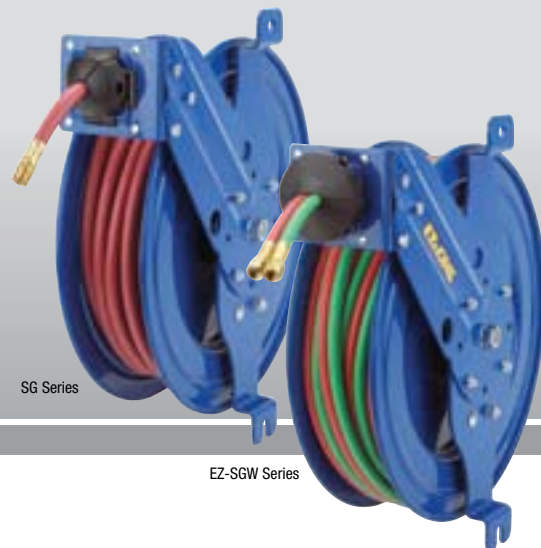
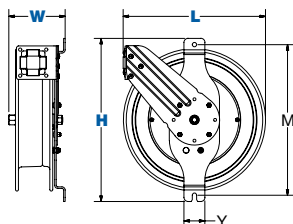

SG Series

EZ-SGW Series

SG SERIES :: REEL SPECIFICATIONS

SWIVEL

- External fluid path with machined from solid brass 90° full-flow NPT swivel inlet (Zinc plated steel swivel on HP models)
- Swivel Seals: NITRILE
- External fluid path with 90° full-flow dual ported brass swivel offering both connections from the same side of the reel (On SGW Models)
- Swivel Seals: VITON® (On SGW Models)

DESIGN & STRUCTURE

- Side mount design for vertical flat surface, cabinet or enclosed space mounts
- Adjustable 6 position guide arm & roller assembly provide maximum hose control
- 2-bolt mounting pattern easily mounts & detaches for temporary or permanent installation
- Solid one piece, 5 mm steel arm base for maximum stability
- 1” solid steel axle & lubricated precision bearings for smooth rotation

RETRACTION

- Controlled retraction speed up to 80% slower on EZ-COIL models :: See page 7 for details
- Enclosed factory tuned & matched cartridge-style spring motor
- Non corrosive stainless steel spring, pawl & zinc plated ratchet
- Multi-position lock ratchet mechanism secures hose at desired length.
- Non-locking, less ratchet option available (add suffix -BXC)

SIGNATURE FEATURES

- Professional grade heavy duty steel construction
- Durable proprietary CPC™ powder coat process
- Rolled edges & ribbed discs provide strength & safety
- Leading 2-year manufacturer's limited warranty
- Made in the U.S.A. - Sold & Supported Worldwide

POSSIBLE FIELDS OF APPLICATION

- Air/Water Services
- Pneumatic Tools
- Welding Shops
- Service / Mechanic / Utility Vehicles
- Lubrication
- Chemical Fluid Transfer
- General Industrial
- Construction Sites

ACCESSORIZE YOUR REEL :: PG 50

- O-Rings & Swivels
- Hoses
- Assorted Reel Accessories

